

Kiosk Pro Lite Set Up

To collect patient data on iPads in clinic securely Amplitude recommends using a combination of Kiosk Pro Lite and Guided Access. Kiosk Pro Lite can be installed for free in the Apple App Store.

Open the Apple App Store on the iPad. Search for and download the Kiosk Pro Lite app.

While the app is downloading open the iPads Settings. Select General and then Accessibility.

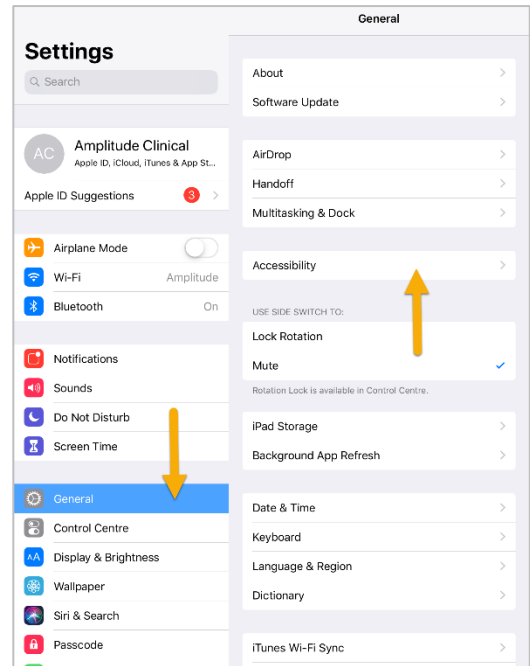
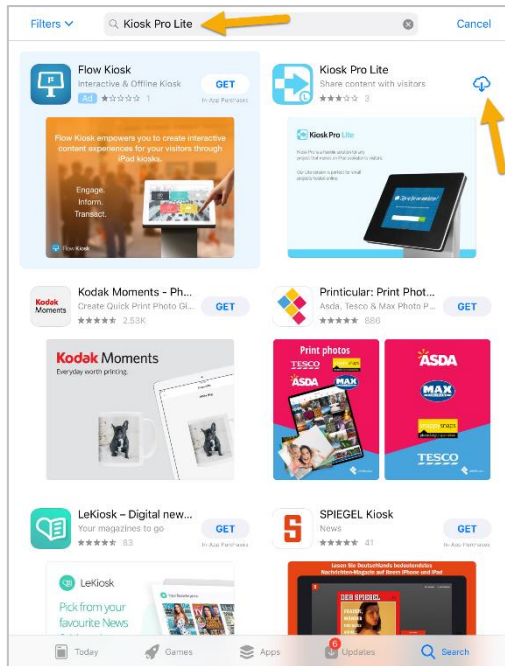

Scroll down and select Guided Access.

Switch Guided Access on and set a passcode to switch this off when needed.

Close the iPad Settings.

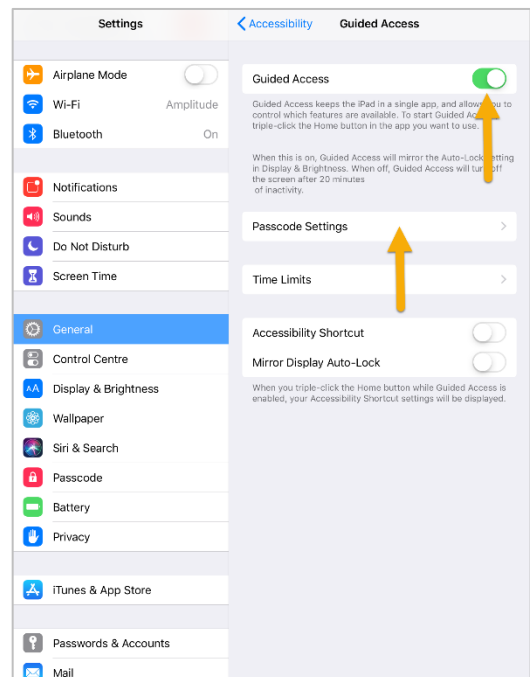
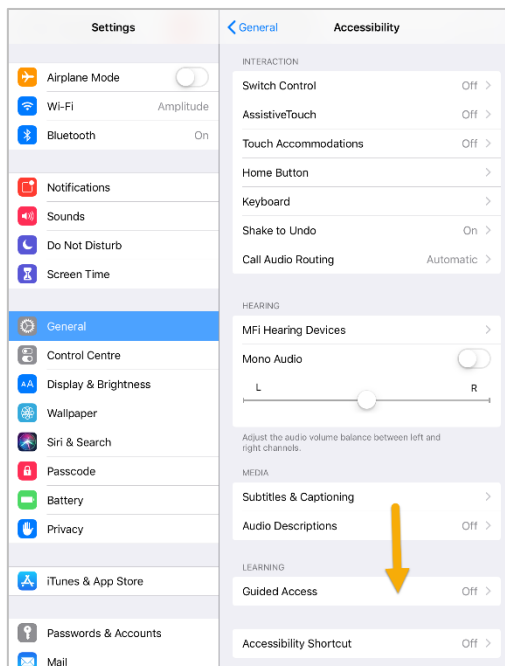

To set up Kiosk Pro Lite for Amplitude you will need to obtain the link to the Patient Portal.

To obtain this open Amplitude and click Settings. Click System Settings and copy the Patient Portal URL.

Open the Kiosk Pro Lite app.

Paste the URL into the 'Homepage Content'.

Run the Kiosk Presentation

This should display the Patient Portal page.

Triple click the iPad Home Button to activate Guided Access, this stops any patients using other apps on the iPads in clinic.

